

HIGH POWER BRAZED ATTENUATOR

2L100040

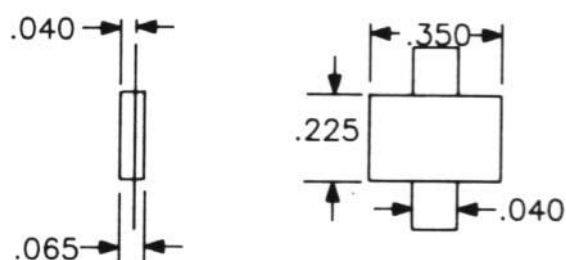

Electrical Specifications		Material Specifications		General Specifications	
RFT P/N	2L100040	Substrate	BeO	Mechanical Tolerance	±.010"
Power (Watt)	100	Backside	Gold	Tolerance (dB)	DC – 1 GHz: ± .5 1-2GHz ± 1
Attenuation (dB)	4	Tab	Nickel with Gold plating	Power Handling	100@ 100°C 0 W @ 250 °C
Frequency (GHz)	2	Cover	Alumina	Construction	Brazed
VSWR	DC – 1 GHz: 1.10:1 1-2 GHz:1.25:1	Resistive Element	NiChrome	RoHS Compliance	Yes

All dimensions are in inches. Minimum lead length 0.125". Other attenuation and tolerance values available.

2245 Fortune Drive, San Jose, CA 95131 Phone: (408) 433-1941 Fax: (408) 433-1943

	CAGE CODE 0NR42	100W 4dB Attenuator	
		Dwg. No: 2L100040	Rev. A