

HIGH POWER BRAZED ATTENUATOR

2L100020

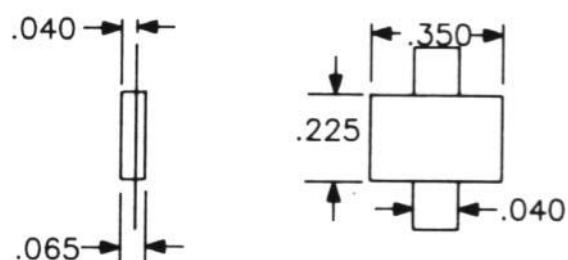

| Electrical Specifications | | Material Specifications | | General Specifications | |
|---------------------------|--------------------------------------|--------------------------|--------------------------|-----------------------------|--------------------------------|
| RFT P/N | 2L100020 | Substrate | BeO | Mechanical Tolerance | ±.010" |
| Power (Watt) | 100 | Backside | Gold | Tolerance (dB) | DC – 1 GHz: ± .5 1-2GHz ± 1 |
| Attenuation (dB) | 2 | Tab | Nickel with Gold plating | Power Handling | 100@ 100°C 0 W @ 250 °C |
| Frequency (GHz) | 2 | Cover | Alumina | Construction | Brazed |
| VSWR | DC – 1 GHz: 1.10:1 1-2 GHz:1.25:1 | Resistive Element | NiChrome | RoHS Compliance | Yes |

All dimensions are in inches. Minimum lead length 0.125". Other attenuation and tolerance values available.

2245 Fortune Drive, San Jose, CA 95131 Phone: (408) 433-1941 Fax: (408) 433-1943

| | | | |
|---|---------------------------|----------------------------|--------|
|  | CAGE CODE 0NR42 | 100W 2dB Attenuator | |
| | | Dwg. No:2L100020 | Rev. A |