

# HIGH POWER BRAZED ATTENUATOR

## 2E100040

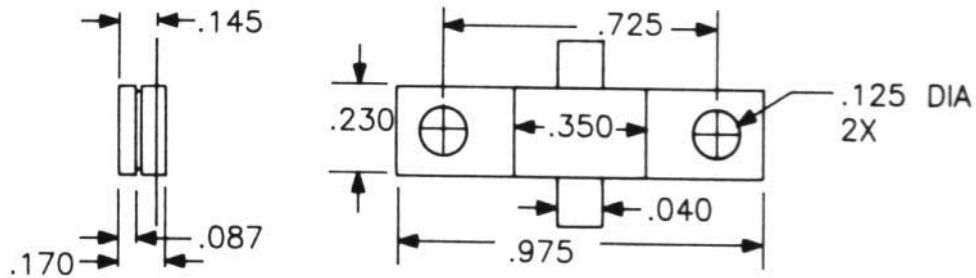

Electrical Specifications		Material Specifications		General Specifications	
<b>RFT P/N</b>	2E100040	<b>Substrate</b>	BeO	<b>Mechanical Tolerance</b>	±.010"
<b>Power (Watt)</b>	100	<b>Flange</b>	Copper with Nickel Plating	<b>Tolerance (dB)</b>	DC – 1 GHz: ± .5
<b>Attenuation (dB)</b>	4	<b>Tab</b>	Nickel with Silver plating	<b>Power Handling</b>	100@ 100°C 0 W @ 250 °C
<b>Frequency (GHz)</b>	4	<b>Cover</b>	Alumina	<b>Construction</b>	Brazed
<b>VSWR</b>	DC – 1 GHz: 1.10:1 1-2 GHz: 1.25 2-4 GHz: 1.35:1	<b>Resistive Element</b>	NiChrome	<b>RoHS Compliance</b>	Yes

All dimensions are in inches. Minimum lead length 0.125". Other attenuation and tolerance values available.

2245 Fortune Drive, San Jose, CA 95131 Phone: (408) 433-1941 Fax: (408) 433-1943

	<b>CAGE CODE</b> 0NR42	<b>100W 4dB Attenuator</b>	
		Dwg. No: 2E100040	Rev. A